

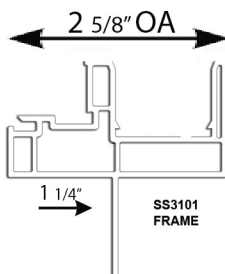

SOLID VINYL WINDOWS



MADE IN TEXAS

MFG. LIMITATIONS

*single unit limitations.

	Width
Minimum	12"
Maximum	48"
	Height
Minimum	24"
Maximum	84"

• minimum width and heights are determined by process machinery capabilities

BASELINE PERFORMANCE

NFRC Values

GLASS	U-VALUE	SHGC VALUE
Clear	.50	.68
Low-E 366 Air	.33	.23
Low-E Arg	.30	.22

Structural Performance

Air Infiltration	@25MPH	.08cfm/ft2
Water Penetration		4.5psf
Uniform Loads		+/- 45psf

AAMA RATING: H-LC30 Optional DP ratings available

FEATURES & BENEFITS

- Dual Sweep Lock. Exceeds forced entry requirements.
- 3/4" Insulated glass standard.
- Dual weather-stripping.
- Full 1 1/8" integral nail fin.
- 2 5/8" Double wall frame for increased rigidity and thermal performance.
- Constant force balance standard.
- Integrated straight, bay and bow mull available.
- Optional two piece field mulling system.
- Full family of Single Hung, Single Slider, 3-lite Slider and Picture Windows.
- LowE3 Double Strength glass standard.
- WOCD Approved locks available.
- Lock and meeting rails reinforced.
- Continuous Head and Sill on Twins and Triples optional.

ASSEMBLIES

Side View

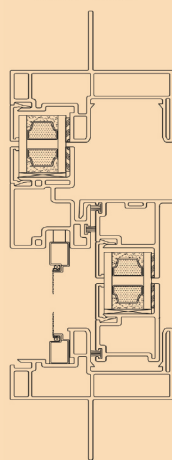

TopDown View

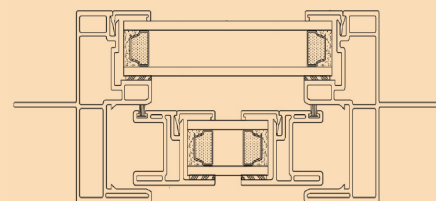

Fort Worth, Texas 76119

AmericanWindowSystems.com



August 2015

SSH31WW SINGLE HUNG

